

DESIGN PRESSURE = ±35 PSF (ANNEALED GLASS)  
±70 PSF (TEMPERED GLASS)

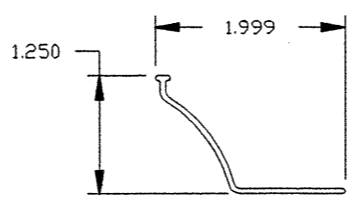

\* MOUNTING CLIP TO BE 1-1/2" WIDE WITH WALL THICKNESS OF .058

MOUNTING CLIP

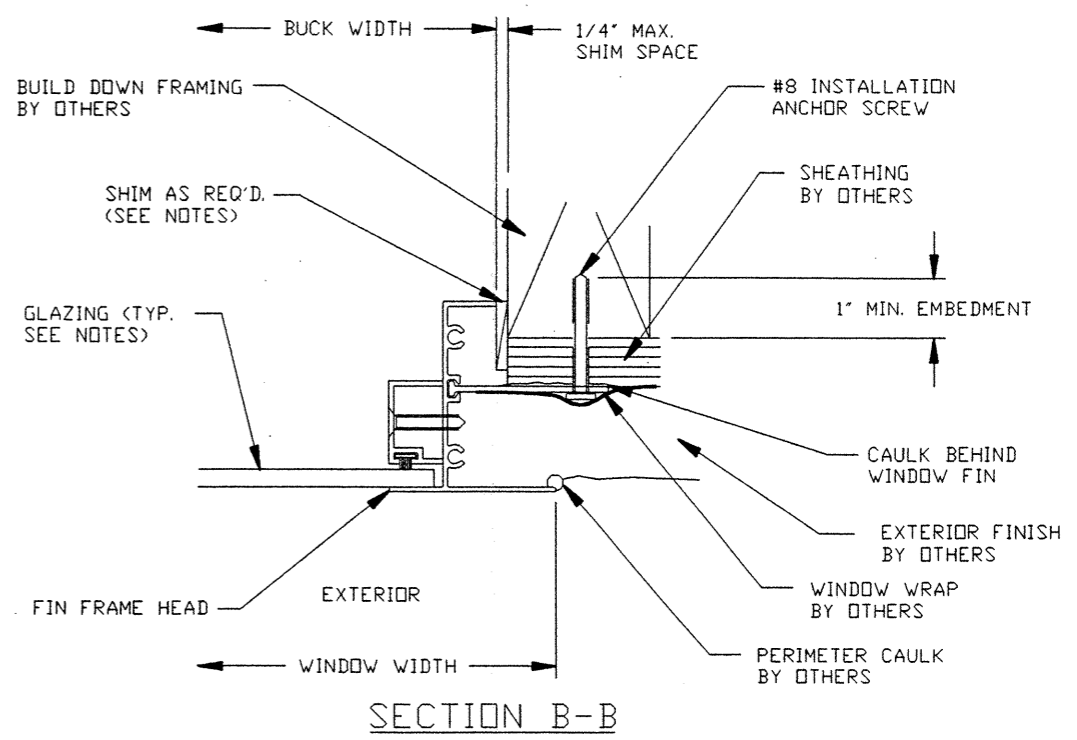

- NOTES:
- 1) WINDOW FRAME MATERIAL: ALUMINUM ALLOY 6063.
  - 2) CONCRETE INSTALLATION ANCHOR MUST BE OF SUFFICIENT LENGTH TO ACHIEVE 1-1/4" MIN. EMBEDMENT INTO MASONRY OR CONCRETE. #8 INSTALLATION ANCHOR SCREWS MUST BE OF SUFFICIENT LENGTH TO ACHIEVE MIN. EMBEDMENT OF 1" INTO WOOD FRAME MEMBER. PLACE INSTALLATION ANCHORS & SCREWS 3" MAX. FROM CORNERS & 24" O.C. MAX.
  - 3) CAULK BEHIND WINDOW FIN WITH LATEX CAULK.
  - 4) USE LATEX CAULK FOR PERIMETER SEAL AROUND EXTERIOR OF WINDOW FLANGE.
  - 5) IF EXACT WINDOW SIZE IS NOT LISTED IN ANCHOR CHART, USE ANCHOR QUANTITY LISTED WITH NEXT LARGER SIZE.
  - 6) GLASS THICKNESS MAY VARY PER THE REQUIREMENTS OF ASTM E1300 GLASS CHARTS. SINGLE GLAZING IS SHOWN. INSULATING GLASS ALSO QUALIFIED.
  - 7) BUILD DOWN AROUND CURVED PORTION OF WINDOW FRAME TO BE ENGINEERED BY OTHERS. BUILD DOWN MUST BE OF SUFFICIENT STRENGTH TO ADEQUATELY TRANSFER LOAD FROM WINDOW TO THE STRUCTURE.
  - 8) FACTORY PUNCHED HOLES IN FIN JAMB DO NOT REQUIRE INSTALLATION SCREWS. IF APPLICABLE, INSTALLATION ANCHORS ARE ONLY REQUIRED THRU FIN AS SHOWN ON THIS SHEET.
  - 9) SHIM AS REQUIRED ADJACENT TO EACH INSTALLATION ANCHOR WITH LOAD BEARING SHIM. MAX. ALLOWABLE SHIM STACK TO BE 1/4". USE SHIMS WHERE SPACE IS GREATER THAN 1/16".
  - 10) ELEVATIONS SHOW COMMON CONFIGURATIONS. IT IS NOT INTENDED TO LIMIT USE OF THIS PRODUCT TO THESE TWO CONFIGURATIONS. THIS SHEET APPLIES TO ALL CONFIGURATIONS THAT CAN BE MANUFACTURED FROM THE 4000 SERIES DESIGNER FIXED FRAMING WINDOW.
  - 11) INSTALLATION AS STATED HEREIN COMPLES WITH THE FLORIDA BUILDING CODE.
  - 12) MAX. ALLOWABLE SIZES:  
ANNEALED GLASS UNITS = 73-1/2" X 61-1/4"  
TEMPERED GLASS UNITS = 84" X 72-1/2"

|   |               |                  |
|---|---------------|------------------|
| CUSTOM WINDOW SYSTEMS, INC.<br>OCALA, FLORIDA   |               |                  |
| TITLE: SERIES 4000 FIN DESIGNER FIXED WINDOW<br>INSTALLATION DRAWING IN MAS'Y. W/BUILD DOWN |               |                  |
| ENGINEER: MANUEL MARTINEZ   | DRN: BB       | DATE: 3/26/02    |
| DISCIPLINE: CIVIL   | SCALE: N.T.S. | DWG. NO: CWS0125 |
| FL. REG. NO: 47182  | REV. LETTER:  | SHEET: 1 OF 1    |