

NOTES:

- 1) ALL ALUMINUM EXTRUSIONS ARE ALLOY 6063-T5 OR T6 WITH TYPICAL WALL THICKNESS OF 0.062".
- 2) THIS DRAWING IS VALID FOR ONLY THE INSTALLATION OF 437 NORANDEX PRODUCTS.
- 3) THE RESPONSIBILITY FOR SELECTION OF NORANDEX PRODUCTS TO MEET ANY APPLICABLE LOCAL LAWS, BUILDING CODES, ORDINANCES OR OTHER SAFETY REQUIREMENTS REST SOLELY WITH THE ARCHITECT, BUILDING OWNER OR CONTRACTOR.
- 4) INSTALLATION HOLES ARE FACTORY PREPUNCHED TO MANUFACTURERS' RECOMMENDATION MAX SPACING 6" FROM CORNERS AND TYPICAL 24" O.C.
- 5) GLASS THICKNESS BASED ON ASTM E 1300 GLASS CHARTS, AND MAY VARY DEPENDING ON SIZE.
- 6) SHIMS ARE OPTIONAL, MAX SHIM STACK 1/4".
- 7) THE WINDOW SIZES SHOWN ARE MAXIMUM SIZES AND INSTALLATION DETAIL INCLUDES OTHER SIZES UP TO MAXIMUM SIZE.
- 8) WOOD BUCKS NOT BY NORANDEX MUST SUSTAIN IMPOSED LOADS. CONTRACTOR IS RESPONSIBLE FOR MAINTAINING STRUCTURAL INTEGRITY OF THE WINDOW OPENING AND ANY WOOD FRAMING AROUND WINDOW HEADER.

DESIGN PRESSURE = ±45

# 10 X 1-3/4" P.H. S.M.S. OR 8d RING SHANK NAILS W/1-1/2" MIN. EMBEDMENT SEE ELEVATION FOR ANCHOR SPACING.

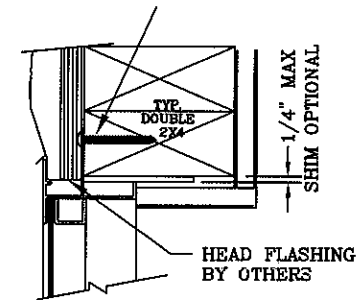

ALL SH FASTENERS ARE #10 P.H. F.H. S.M.S. OR 8d RING SHANK NAILS WITH 1-1/2" EMBEDMENT INTO 2 BY BUCK

*W.A. Davis Jr.*  
9/3/02  
W.A. DAVIS JR. P.E.  
FL REG. ENG. # 25539  
DATE: 9/3/02

438 DBL SH W/ DW OVER  
SELF STACKING SILL  
INSTALLATION DETAIL

SERIES: 437  
ALUMINUM WINDOW  
**NORANDEX**  
4606 30th STREET WEST  
BRADENTON, FL 34207  
PHONE: (941) 766-1691

NO.	DATE	DESCRIPTION

DATE: 9/9/02  
SCALE: N.T.S.  
DWG. BY: RAE  
CHK. BY:  
DWG. NO.: MAR-011